

Leddin Ancestors

Margaret Leddin was christened 8 March 1841 in Emly, County Tipperary, Ireland, the daughter of John Leddin and Mary Morrissy.

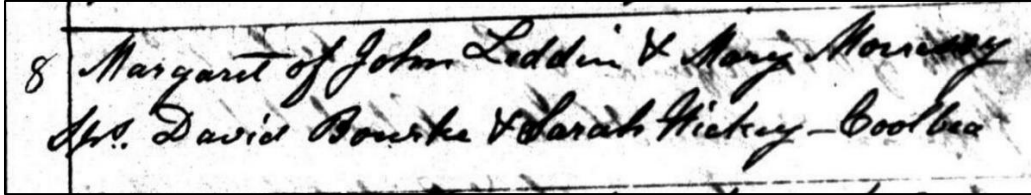

Christening record for Margaret Leddin in Emly:

"8 - Margaret of John Leddin & Mary Morrissy, Sps: David Bourke & Sarah Hickey - Coolbea"

The recent availability of parish registers and civil registration online have provided greater insight into Leddin family groups. In addition to the information on this branch of the Leddin family, a good deal of information on the Leddins has been accumulated in the search, and is available on the [Leddin Research](#) page.

FAMILY RECORD OF JOHN LEDDIN AND MARY MORRISSY

John Leddin married Mary Morrissy 27 February 1838 in Galbally, County Limerick, Ireland. The witnesses were Michael Morrissey and Catherine Morrissey.

John and Mary settled in the townland of Coolbea (Coolboy), in Emly, an adjoining parish.



Parish map for the parishes near Emly

John Leddin first appeared in Emly parish in 1831, when he acted as a sponsor for Mary, the daughter of William and Joanna Brasil.

27 Mary of William & Joanna Brazil Sp.
John Leddin & Mary Dealy - Ardglaf

Christening record in Emly, showing John Leddin as a sponsor

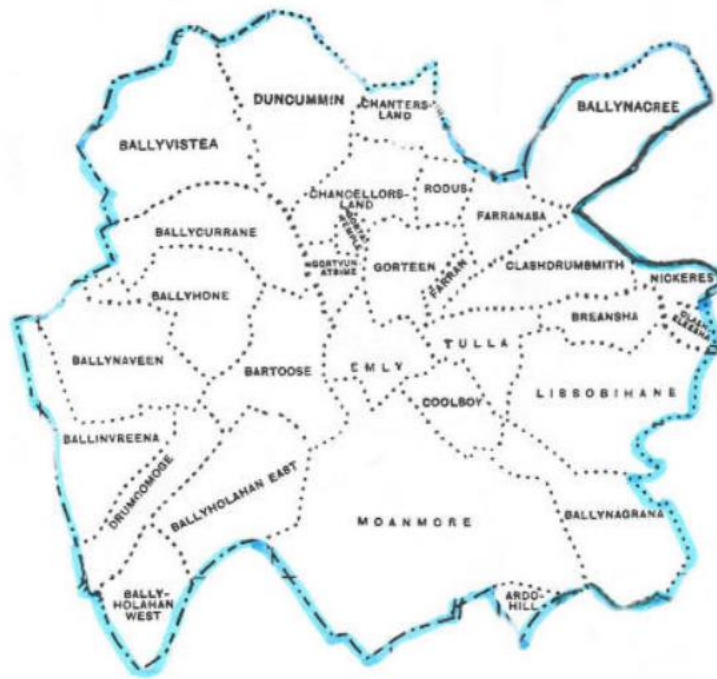

Townlands in Emly parish

In 1834, John Leddin and Ellen Purcell were sponsors for James, the son of William Bourke and Mary Phleming of the townland of Moanmore in Emly.

James of William Bourke & Mary Phleming
Mr. John Leddin & Ellen Purcell - Moanmore

Christening record in Emly, showing John Leddin and Ellen Purcell as sponsors

John Leddin married Ellen Purcell 2 March 1835 in Emly, in the presence of Philip Purcell, John Fleming and Catherine Purcell. John was shown as being of Monmore (Moanmore). Philip Purcell lived and rented land in Moanmore in Griffiths Valuation of 1851.

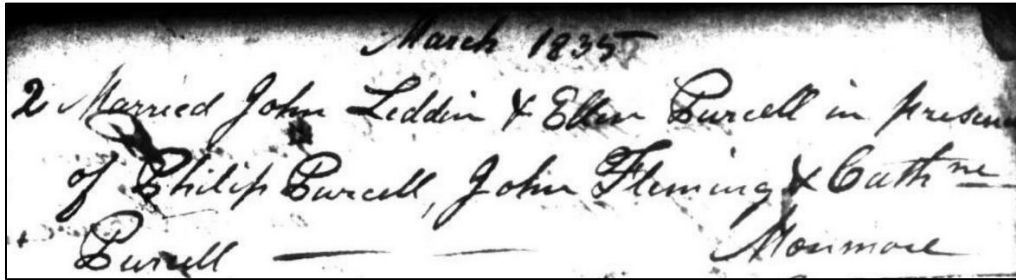

Marriage record for John Leddin & Ellen Purcell in presence of Philip Purcell, John Fleming & Catherine Purcell - Monmore"

John Leddin and Ellen Purcell had the following children:

1. **John**, christened 7 January 1835 in Emly, sponsors: John Purcell and Eliza Purcell. The Leddins are shown as being of the townland of Ardglass.
2. **Margaret**, christened 5 October 1837 in Emly, sponsors: Mary Purcell. The Leddins are shown as being of Rodis. Margaret may have died young.

Ellen must have died, because John then married Mary Morrissy 27 February 1838 in Galbally, a parish about five miles from Emly.

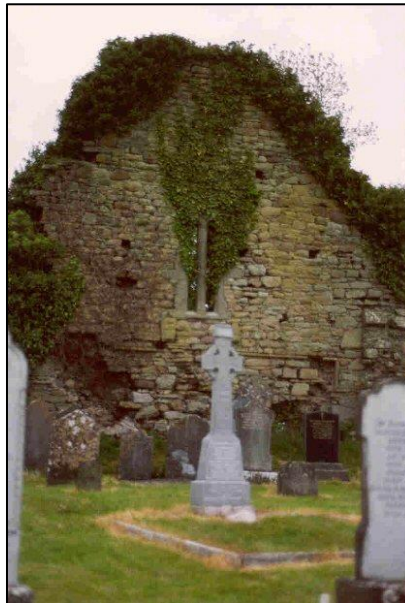

Galbally Churchyard

John and Margaret had the following children:

*1. **Margaret**, christened 8 March 1841 in Emly; emigrated to Chicago in 1868; married Maurice Hickey 5 February 1872 in Chicago; died 19 July 1925 in Chicago.

2. **Michael**, christened 1 November 1844 in Emly; emigrated to Chicago; married Bridget Cosgrove; worked on the railroad; had children John (1879), and Patrick Joseph (1881); Bridget died in 1881; Michael died 14 January 1893 in Chicago. His obituary read: "*Ledden, Michael, Jan. 14, 1893, husband of Bridget, nee Cosgrove, and brother of Mrs. Maurice Hickey, aged 42 yrs., native of Emly, Co. Tipperary. Funeral from Cook County Hospital to St. Jarlath's Church to Calvary.*" (*Chicago Irish Families, 1875-1925, citing Chicago Daily News, in ancestry.com.*)

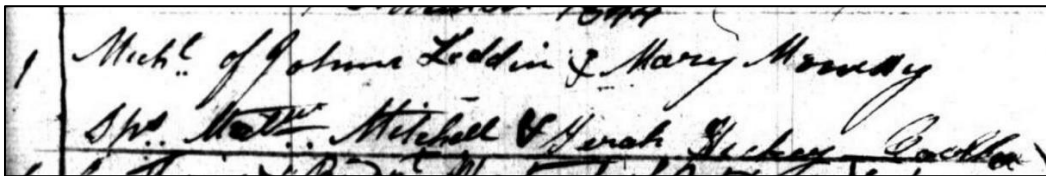

Christening record for Michael Leddin in Emly:
"Michl of John Leddin & Mary Morressy,
Sps: Mathew Mitchell & Sarah Hickey, Coolbea"

John Leddin is found in Coolbea (Coolboy) townland in Emly in Valuation Records in the 1840s. Land records called Tenure Books were created in 1847 in preparation for Griffiths Valuation. This record gives details of John Leddin's lease.

5A B.c.	Mary Bourke James Scully Esq. house offices & garden	16-0-0 3-10-0	On a lease of lives
B.c.	John Leddin from Mary Bourke house & garden	2-15-0	yearly

Tenure Book for Coolboy townland, Emly, in 1847

The Tenure Book shows that John Leddin leased a house and garden from Mary Bourke at a cost of £2-15-0 yearly. The former landlord had been William Bourke.



The townland of Coolbea, looking down the road from the old train station at the Burke's farm

The House Books are other records created in preparation for Griffiths Valuation. They show John Leddin in Coolboy in 1849.

Houses in Townland of *Coolboy*

No.	Name and Description.	Quality Letter.	Length.	Breadth.	Height.	Number of Measures.	Rate per Measure.	Amount.
1-	Michael Rowlett							
	House	36	46.0	10.5	8.7	7	2-10-9	
	Office Barn	36	45.0	7.5	8.0	10	1-3-4	
	Office Pigpen	36	40.0	10.0	6.6	41	0-8-6	
	settled 3.5.0							4.2-7
2-	James Taylor							
	Johnnie Lambert	36	28.0	18.0	6.0	57	2-2-2	4.2-8
	House							0-10-7
	settled 2.0.0							6.10-5
	John Gray Rowlett							0.10.0
	House	36	42.0	20.0	7.9	84	2-9-9	
	Office Barn	36	24.0	13.0	5.9	31	0-5-10	
	Office Pigpen	36	13.0	10.0	5.0	14	0-2-4	
	Office Stable	36	0.0	6.0	5.0	13	0-2-2	
	settled 1.1.0							2-10-7
3-	John Leddin							
	House	36	24.0	13.0	5.3	31	0-4-7	12-11
	settled 1.1.0							10-13.0
4-	John Rowlett							
	House	36	27.0	22.0	7.9	101	2-12-7	
	Office Barn	36	40.0	15.0	6.9	66	0-17-10	
	settled 3.10.0							0-14-11
5-	Edmond Rowlett							
	House	36	31.0	17.0	5.0	55	0-14-11	
	Office	36	57.0	17.0	7.0	95	1-14-7	
	settled 3.7.0							3-5-10
	settled 3.7.0							5-3-5

House Book, Coolboy, Emly showing John Leddin's house, 1849

John Leddin lived in a house that was 24.6 feet long by 13 feet wide, and 5.6 feet high. The condition of the house was 3b+. That means that it was a thatched house of stone walls with mud mortar, or mud walls of the best kind. The condition was medium (not new), but in sound order, and good repair. There were no barns, stables, piggeries or other outbuildings.



Old railway station in Coolboy

The Land Book was another record created in preparation for Griffiths Valuation. In Emly, it was taken in 1851.

Home & office	18	0	9	25.0	21	13	4
	0	0	15				
5 th William Burke				21.0			
5 th Mary Burke	2	1	37	22.0	26	8	2 12 1
A. house & office	22	2	17	25.0	24.0	27	2 6
John Leddin	0	0	20				
Garden				72.3			
to Home	0	1	11	23.0	0	7	1
Total	2	3	28				
6 th Great Southern & Western Railway				15.0			
6 th Station ground	0	2	22	26.0			0-16-1
This was part of old 3a	0	3	18	20.0			1-3-1
	<u>157</u>	<u>0</u>	<u>10</u>				<u>194-18-6</u>

Land Book for Coolboy, Emly, 1851

John Leddin is found on Lot 5Bb. He has a house and garden. His neighbor on Lot 5B was his landlady Mary Burke. His other neighbor, on Lot 6 was the Great Southern & Western Railway. It has a note in pencil: "Station ground, This was part of old 3a."



*Ordinance Survey map of Coolboy
John Leddin's home is Lot 5b, the tiny lot in the center.
A small house can be seen at the top of the lot.*

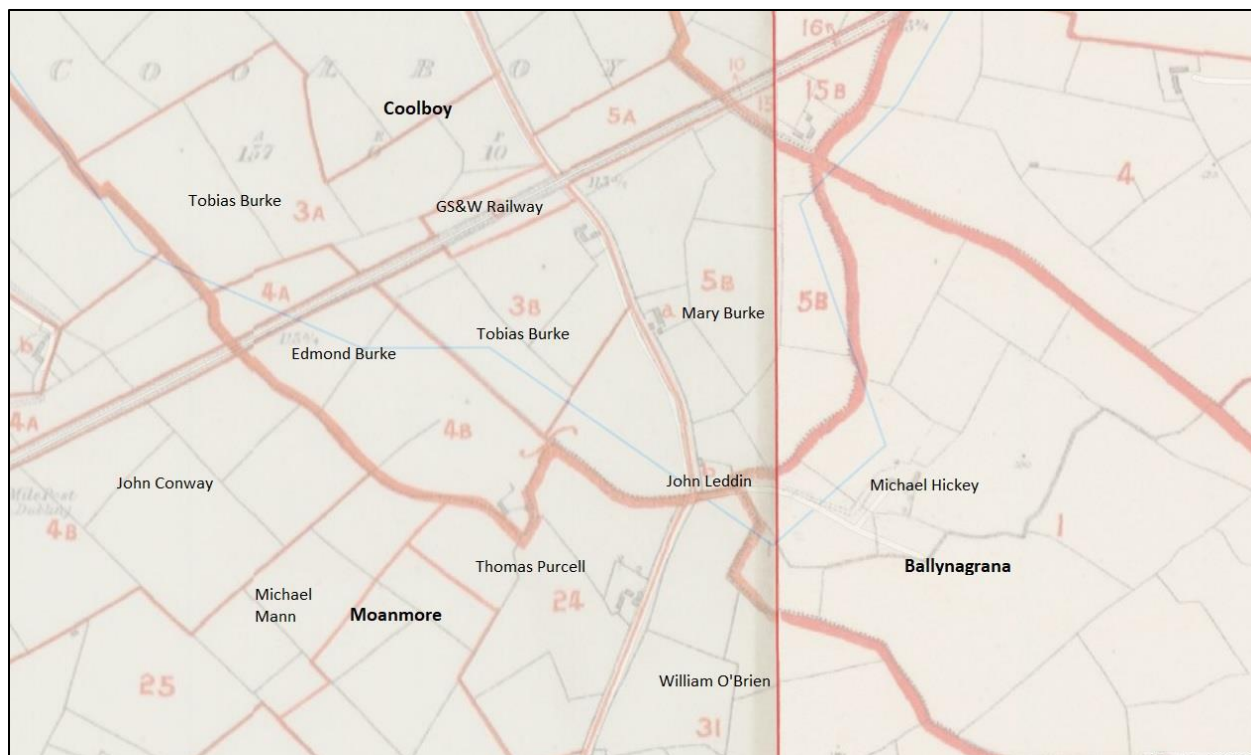

*The neighbors - John Leddin's home was at the bottom of Coolboy, near the intersection of Coolboy, Moanmore and Ballynagrana
His neighbors on the north were the Burke family*

The area of Coolbea (or Coolboy) is 157 acres. A history of Emly lists the residents of Coolbea: “Four of the six tenants in Coolboy in 1830 were Bourkes — Edmund Sen. and Jun., David and William. The other tenants were John Glasheen who did not live here and the Rev. John Seymour who lived in the Glebe house (Emly House). There were seven houses in Coolboy in 1841 and six houses ten years later. The population fell from 55 to 46 during the same period. There were still four Bourke families here in 1850 — Michael, Tobias, Edmund and Mary. John Leddin and Michael Corbett each had a house and garden here then. The G.S. and W. Railway had built the railway station here in 1849 and their property covered four acres of townland.” The parish priest of Emly explained that John most likely came to Emly with the railroad and worked for the railroad.

Griffiths Valuation of 1851 showed John on the same property, with a house and garden. He had less than an acre of land, so was not farming.

PRIMARY VALUATION OF TOWNLANDS.
PARISH OF EMLY.

76

No. and Letters of Reference to Map.	Names		Description of Tenement.	Area.	Net Annual Value.		
	Townlands and Occupiers.	Immediate Lessors.			Land.	Buildings.	Total.
				A. R. P.	£ s. d.	£ s. d.	£ s. d.
COOLBOY—con.							
-	a	Michael Corbett,	John Glasheen,	House,	—	0 6 0	0 6 0
3 A	a	Tobias Burke,	James Scully, Esq.	Land,	19 2 8	24 15 0	24 15 0
- B	a	Tobias Burke,	James Scully, Esq.	House, offices, and land,	10 3 33	14 15 0	16 15 0
4 A	a	Edmond Burke,	James Scully, Esq.	Land,	2 0 6	2 5 0	2 5 0
- B	a	Edmond Burke,	James Scully, Esq.	House, offices, and land,	18 0 24	21 15 0	23 15 0
5 A	a	Mary Burke,	James Scully, Esq.	Land,	2 1 37	2 10 0	2 10 0
- B	a	Mary Burke,	James Scully, Esq.	House, offices, and land,	22 2 37	27 0 0	28 5 0
-	b	John Leddin,	Mary Burke,	House and garden,	0 1 11	0 7 0	0 7 0
6		G. S. & W. Railway Co.	In fee.	Land and railway,	4 1 28	5 10 0	5 10 0
Total.				157 0 10	198 12 0	7 19 0	206 11 0

Griffiths Valuation for Coolboy townland, Emly

John Leddin leased a house and garden from Mary Burke on Lot 5Bb.

No death record has been found for John or Mary Leddin, and Michael was the last of their children recorded in the Emly parish register in 1845. No gravestone inscriptions are found in the Emly cemetery.

Both Margaret and Michael emigrated to Chicago. Michael was called a native of Emly in his obituary, and Margaret's daughter recorded Emly as her birthplace, so they both regarded it as their hometown. Neither John nor Mary were listed in Emly the 1871 census fragment for Emly, so may be deceased by 1871. Margaret had already emigrated to America.

1871 Irish Census, Emly

COOLBOY

Margaret Burke

Michael Glasheen

Roger Bernane

Tobias Burke

Edmund Burke, Sr.

Edmund Burke (Minor)

Michael Power

Gt S & W Ry., Molloy, Sec.

SOURCES: Emly parish register; Galbally parish register; Griffiths Valuation, Emly; Tenure Book, Emly; House Book, Emly; A History of Emly; Chicago Irish Families, 1875-1925, citing Chicago Daily News, on www.ancestry.com; 1871 Irish census, Emly, County Tipperary.

Who were John Leddin's parents?

John Leddin was born in about 1810, so his birth likely pre-dates the parish registers. No Leddins are found having children in the early Emly parish register. John may have been born in one of the

neighboring parishes of Galbally, Hospital, or Knocklong. all within about five miles of Emly, where many Leddins are found.

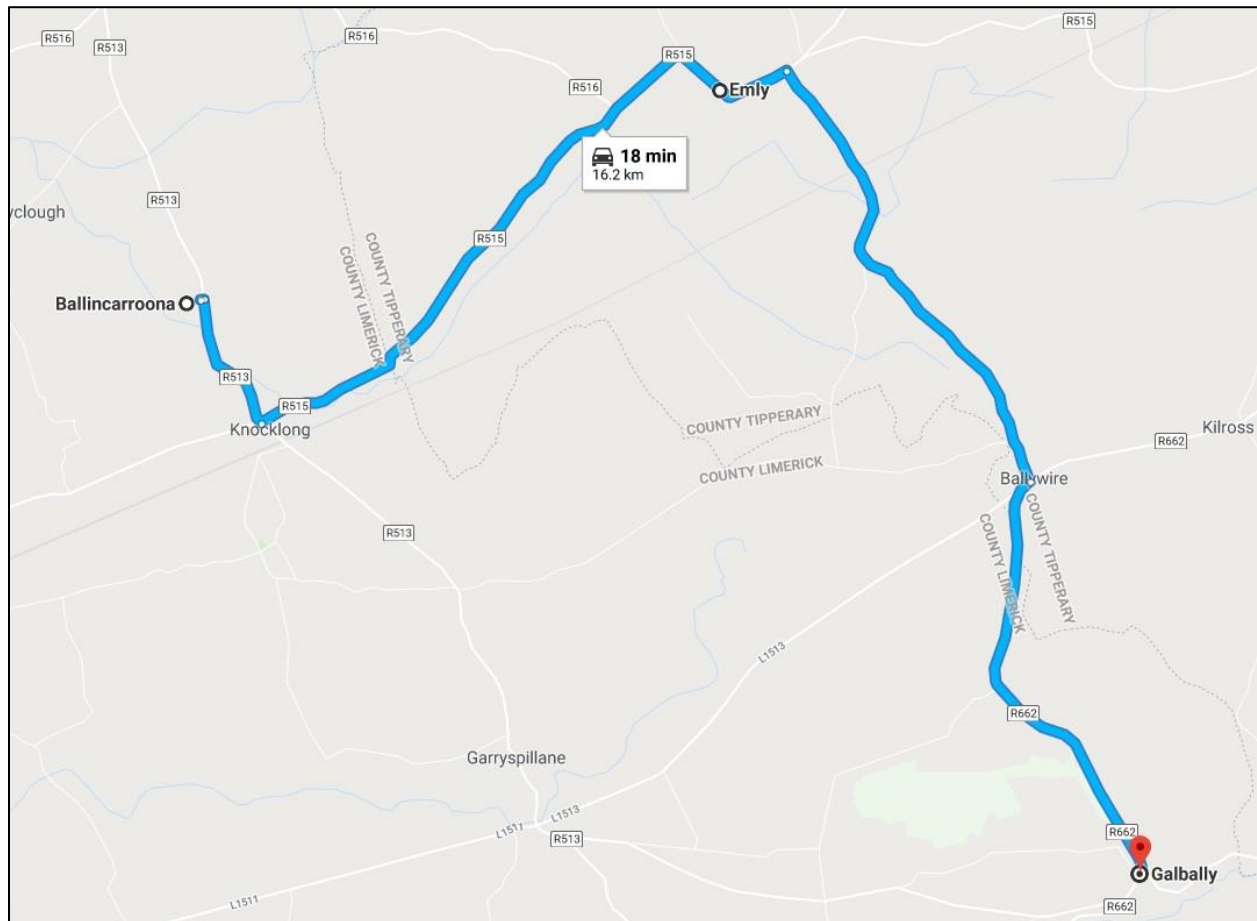

The Leddins on the Limerick/Tipperary border seem most likely to be related, and are found in groups in Emly, Ballycahill in Hospital, Ballincarroona in Kilfrush and Knocklong, and Galbally. The parish registers in those parishes started about 1810. Records of leaseholders were taken in about 1830 at the Tithe Applotment, and in Griffiths Valuation in about 1850, and can provide some information about Leddins in the area. The Valuation Books written in preparation for Griffiths give information about the size and type of house they occupied, the land they worked, and the terms of the lease they held. Monumental inscriptions on gravestones can be one of the most helpful resources for determining pre-19th century family relationships. Some assumptions have to be made in this early time period, due to lack of records. Fortunately, Irish families tend to be stable in their locations. An analysis of Leddins in their townlands can provide some knowledge of these families.

The first appearance of a Leddin in the Emly parish register occurred when **Timothy Leddin** of Hospital married Mary Murphy of Duncummin. They were married in Emly 25 February 1816, and raised their families in Ballycahill, in Hospital parish. Timothy was the son of William Leddin, and was born in about 1792. Timothy was a farmer. He died 20 November 1889 in Ballycahill. Timothy had children christened in Hospital: Judith (1817), William (1819), Michael (1821), Patrick (1823), Catherine (1827), Edmond (1829), John (1831), and Matthew (1835), all born after 1816. Sons William and Edmond both lived and died in Ballycahill. Timothy and Patrick Leddin are found in Ballycahill in the estate records of the Earl

of Kenmare in 1843. The members of this feisty family are also found in newspapers and court records, as they had some involvement in faction fighting. Timothy is not a possible father for John, as his children were born after 1816 and he later had a son named John born in 1831.

The first record for a Leddin in the parish of Galbally, was a christening for Cathy, daughter of **Michael and Mary Leddin** in April 1810 in Galbally. The Galbally parish registers started in 1810.



Baptism record for Cathy, daughter of Michael and Mary Leddin in Galbally

The Tithe Applotment was taken in about 1830. The Leddins/Leddens who are recorded in County Limerick and Tipperary in the Tithe Applotment are:

- ***Michael Leddin in Garrynalina, Galbally parish, Limerick in 1830**
- ***Timothy Ledden in Ballycahill, Hospital parish, Limerick in 1834**
- ***Patk Ledden in Ballincarroona, Kilfrush parish, Limerick in 1833**
- Michael Leddin in Rathbane, Cahernarry parish, Limerick in 1825
- Jas Leddin in Toulegee, Kildimo parish, Limerick in 1825
- John Leddin in Fidane, Kilnarath parish, Tipperary in 1827
- James Leddin in Ballyuenterock, Rathkeale parish, Limerick in 1835
- Patk Ledden in Roulagh, Ballinard parish, Limerick in 1834
- Pat Ledden in Bamecile, Mungret parish, Limerick
- Michael Ledden in Rathbane, St. Nicholas parish, Limerick

*The parishes near Emly are Galbally, Hospital, and Kilfrush. All are within ten miles of Emly. John Leddin of Emly does not appear in the Tithe Applotment, so was not leasing land of five acres or more in the early 1830s, and was probably a laborer. Michael, Timothy or Patrick are all likely to have been of an age to be John's father. Timothy and Patrick were both sons of William Leddin of Knocklong, County Limerick. Timothy married in 1816, after John was born, so was not his father.

Michael Leddin is found in the Tithe Applotment for Galbally parish in 1834 in Garrynalyna townland.

Applotment in British Currency of the Amount of Composition of Tithes of the Parish of GALBALLY of Costlea, and County of Limerick.																				
PAYABLE TO THE REV. JOSEPH PRESTON, INCUMBENT OF SAID PARISH, GEORGE GUBBINS, AND GEORGE MASSY, DEAR COS																				
No.	Townland.	Gross Contents.			Waste.			Occupiers' Names.	Nett Number of Acres.			Value per Acre.			Total Value.			Composition per Acre.		Total A of Comp
		A.	R.	P.	A.	R.	P.		A.	R.	P.	£.	S.	D.	£.	S.	D.	S.	D.	
	(Galbally)				59	0	33	Pro ^{vs} forwards	3081	5	34				£7401	15	8			£313
305	Villa							Dennis Cussen		1	0		2	10	0		12	6		21 1/2
306	Garralina	4	0	2		3	2	Pat ^r Power	3	1	0		1	15	0		5	13	9	13 1/2
307	Villa	1	1	0				Mich ^l Leddin	1	0	34		1	15	0		2	2	5	13 1/2
308	ditto	18	2	0		1	21	Robert Cain	18	0	19		1	10	0		27	3	6	13 1/2
309	ditto	20	2	0		1	2	John Connors	19	0	0		1	15	0		33	5	0	13 1/2
310	ditto	18	0	20		2	3	Michael Ryan	17	1	23		1	10	0		26	14	7	13 1/2
311	ditto	24	0	10		3	20	Shir ^l Ryan	23	0	30		1	10	0		30	13	7	13 1/2
312	ditto	5	2	21		1	0	William Riggs	5	1	21		2	0	0		10	13	3	18 1/2
313	ditto	13	0	0				Don Donovan	12	3	16		1	10	0		14	5	6	13 1/2
314	ditto							St ^r Hanniffy		3	0		1	10	0		1	2	6	13 1/2
315	ditto	8	5	8				Thomas Magner	8	2	25		1	10	0		12	14	8	13 1/2
316	ditto	10	0	17		3	17	George W. Glavin	39	1	0		1	10	0		58	17	6	13 1/2
317	ditto							George W. Glavin	4	0	0			10	0		2	0	0	5 1/2
318	ditto	2	2	10				Daniel Sumner	2	1	30		1	10	0		3	13	17	13 1/2
319	ditto	12	0	0				Mich ^l W. Grath	11	3	20		1	10	0		17	16	3	13 1/2
320	(Ballinacorney)							Edw ^d Magner	20	0	0		1	10	0		30	0	0	13 1/2
					4	65	0	23	Over	3269	2	12					£7688	00	0	£3

Tithe Applotment, Garrynalyna townland, Galbally parish, 1834

Michael Leddin of Garrynalyna townland is found in Griffith's Valuation of 1862. He is also found in the Valuation Lists of 1863, 1873 and 1876. In 1876, possibly at the time of his death, his name is crossed out, and Edmund McCarthy became the tenant. This Michael must have been born between 1776 and 1813, as he must have been at least 21 in 1834 to be a leaseholder, and was not likely to have been more than 100 years old at the time of his death. He is probably the father of Cathy Leddin, who was born in Galbally in 1810, and the husband of Mary Leddin. No other christening records are found in the early Galbally parish records for a child of Michael, although the Tithe and Valuation record indicate that he stayed in the parish. He likely had children before the start of the parish record in 1810. He is a possible father for John Leddin.

There is a christening record for Mary, daughter of Michael Leddin and Mary Ahern, 8 April 1823 in Hospital. This may be the Michael and Mary Leddin who were parents of Cathy Leddin in Galbally.

Patrick Leddin of Ballincaroona was born in about 1782, the son of William Leddin of Knocklong. He married Margaret Gleeson in 1800. Patrick was a farmer. His wife Margaret is buried in the old

Knocklong Cemetery. Her gravestone reads: "*This small testimony of sorrow was erected by William Leddin of Ballencarroona in memory of his mother Margret Leddin alias Gleeson who died the 30 Dec 1841 aged 59 years*".

Patrick and Margaret had the following known children:

1. **William**, born in about 1810, married Johanna Condon 1834 in Galbally.
2. **Mary Ann**, christened 31 March 1813 in Hospital; married Lawrence Bourke 1831 in Hospital.
3. **Margaret**, christened 28 May 1815 in Hospital.
4. **Catherine**, born in Emly; married John Bourke.

John was born before 1810, so Patrick is another possible father for John Leddin.

No other possible fathers for John Leddin are found in or around Emly in the right time period. There are some Leddins of an age to be brothers. Either Michael or Patrick could be John's father. John did have a son named Michael, but he also named two daughters Margaret, which was Patrick's wife's name (and John's possible mother).

Possible brothers - Another **Michael Leddin** married and had children in Emly at about the same time as John Leddin. Michael Leddin of Ballinvriana townland in Emly married Ellen Ryan 4 January 1831 in Emly, so was likely born in about 1805. Michael may be John's brother. Records are found in Emly for Michael, William and John Leddin between 1831 and 1853, so they are possibly brothers.

Michael and Ellen had the following children:

1. **John**, christened 24 June 1833 in Knocklong.
2. **Ellen**, christened 20 June 1836 in Knocklong.
3. **Judith**, christened 6 October 1838 in Knocklong.
4. **Maurice**, christened 23 November 1839 in Knocklong.

William Leddin, the son of Patrick Leddin and Margaret Gleeson, was born in about 1810 and married Johanna Condon 9 February 1834 in Galbally. William had two children born in Emly parish in 1851 and 1853, so was in the parish at the same time as John Leddin. William is another possible brother for John Leddin.

William Leddin of Emly appeared in the Irish Petty Court Session Records on 24 June 1852 for "*allowing your horse to wander on a public road*".

PARTIES—COMPLAINANT AND DEFENDANT. (The Christian and Surname, Rank, Occupation, or other addition, and Residence, stating Parish and Township, to be given, and the parties to be distinguished by prefixing their appellation—Complainant or Defendant.)	Names of Witnesses examined, and whether for Complainant or Defendant.	CAUSE OF COMPLAINT, as set forth in Summons.	PARTICULARS OF ORDER If Dismissed, whether with or without prejudice, and if in Ejectment, when to be evicted, and from what &c. If to be Whipped, whether in or out of Prison, &c. (Where Money ordered to be paid by or to any party words at full length in this Column, as well as Money Columns.)
<i>Patrick Mc Gann Sub Constable of Emly Complainant Michael Dealy of Castlemore Parish Emly Defendant</i>	<i>P. M. Moran for Complainant</i>	<i>for allowing your Horse to wander on the public road at Castlemore on the 18th instant</i>	<i>Fixed Sumpens and for Costs</i>
<i>Same Complainant William Leddin of Emly Parish of Emly Defendant</i>		<i>same offence at Tulla</i>	<i>Fixed Sumpens and for Costs</i>

William Leddin of Emly in the Petty Session Records

William and Johanna had the following children:

1. **Margaret**, christened 10 July 1835 in Hospital; married Richard Wilson; died 1897.
2. **Mary**, christened 9 July 1837 in Hospital; married Thomas Madden; died 1893.
3. **Patrick**, christened 19 April 1839 in Hospital; married 1) Jane Sinnott, 2) Mary Dalton; died 1886.
4. **John**, christened 7 August 1841 in Hospital; married 1) Catherine O'Shannessy, 2) Maryann Carroll; died 1902.
5. **Elizabeth**, christened 10 July 1844 in Hospital; married John Dalton in Australia; died 1932.
6. **Anne**, christened 4 December 1846 in Hospital; married William Sinnott; died 1912.
7. **William**, christened 9 February 1851 in Emly; married Johanna Dalton; died 1933.
8. **Johanna**, christened 20 April 1853 in Emly; married Francis Dalton; died 1925.
9. **Bridget**, christened 29 July 1855 in Knocklong; married John Dwyer; died 1934.

William and Johanna and their children emigrated to Australia in 1857. All of William and Johanna's children married in Australia. A descendant reported that William came from Emly: "*William Leddin 1812-1866, son of Patrick Leddin and Margaret Gleeson, married Johanna Condon 1813-1885, daughter of John Condon and Johanna Holloway. They had a family of nine children in Ireland, seven of which traveled to Australia with their parents. Margaret and Mary, the two eldest came out before the rest of the family. William Leddin came from Emly in Co. Limerick near Tipperary. The Leddin family traveled on the Chance, which sailed from Liverpool, England and called into Irish Ports They arrived in Belfast, Victoria, Australia, now Port Fairy on 12-9-1854:*

William 45 years, Julia (Johanna) 44, Patrick 17, John 15, Betsy (Elizabeth) 12, Ann 10, William 6, Johanna 3, and Bridget 1 year." (Letter from James O'Brien, Australia)

William Leddin is found in *A List of Loans in the District of Bruff*:

- *William Leddin of Ballincarroona was guarantor for Thomas Norris of Hospital 15 November 1847.*
- *William Leddin of Ballincarroona was guarantor for Thomas Norris of Hospital 22 November 1847.*

Source: *Poverty Relief Loans on www.findmypast.ie*

William is not found in Emly in Griffiths Valuation in 1851, but there is a Valuation record for a William Leddin in Ballincarroona townland, Kilfrush parish, about 4 miles east of Emly.

PRIMARY VALUATION OF TENEMENTS.								59								
PARISH OF KILFRUSH.																
1851																
No. and Letters of Reference to Map.	Names.		Description of Tenement.	Area.	Net Annual Value.											
	Townlands and Occupiers.	Immediate Lessors.			Land.	Buildings.	Total.									
				A.	R.	P.	£ s. d.	£ s. d.	£ s. d.							
BALLINCARROONA (Ord. S. 40 & 41.)																
1	a	William Hennessy.	Joseph Gubbins, Esq.	House, offices, and land,	32	3	0	83	11	0	1	14	0	35	5	0
2	a	John Hennessy.	Joseph Gubbins, Esq.	House, office, and land,	29	2	16	27	15	0	2	0	0	29	15	0
3	a	Patrick Gleeson.	Joseph Gubbins, Esq.	House, offices, and land,	20	0	19	19	0	0	1	15	0	20	15	0
4	a	Patrick English.	Joseph Gubbins, Esq.	House, offices, and land,	30	0	7	28	3	0	1	17	0	30	0	0
5	a	William Kirby.	Joseph Gubbins, Esq.	House, offices, and land,	25	1	14	23	15	0	2	5	0	59	5	0
				Land,	34	3	22	33	5	0						
	a	William Creahan.	William Kirby.	House and garden,	0	1	30	0	9	0	0	9	0	0	18	0
6		Joseph Gubbins, Esq.	Mrs. Jane Vereker.	Land,	198	0	14	220	0	0				220	0	0
7	a	John Canty.	Joseph Gubbins, Esq.	House, offices, and land,	10	3	23	10	10	0	4	15	0	15	5	0
8	a	Vacant.	Joseph Gubbins, Esq.	House and garden,	0	0	24	0	2	0	1	0	0	1	2	0
	b	John Carroll.	Joseph Gubbins, Esq.	House and garden,	0	0	19	0	2	0	1	0	0	1	2	0
	c	John Regan.	Joseph Gubbins, Esq.	House and garden,	0	0	17	0	2	0	1	0	0	1	2	0
	d	Vacant.	Joseph Gubbins, Esq.	House and garden,	0	0	19	0	2	0	1	0	0	1	2	0
	e	John M'Grath.	Joseph Gubbins, Esq.	House and garden,	0	0	21	0	2	0	1	1	0	1	3	0
	f	John Fitzgerald.	Joseph Gubbins, Esq.	House and garden,	0	3	8	0	10	0	1	1	0	1	11	0
9	a	Richard Moloney.	Joseph Gubbins, Esq.	House, offices, and land,	43	0	2	45	15	0	2	10	0	48	5	0
10	a	William Leddin.	Joseph Gubbins, Esq.	House, offices, and land,	23	1	35	20	10	0	1	0	0	21	10	0
11	a	Anne English.	Joseph Gubbins, Esq.	House, offices, and land,	24	1	20	21	8	0	1	17	0	23	5	0
12	a	Thomas Moloney.	Joseph Gubbins, Esq.	House, offices, and land,	26	1	20	24	17	0	1	8	0	26	5	0
13	a	Denis Hennessy.	Joseph Gubbins, Esq.	House, offices, and land,	32	0	6	32	0	0	2	5	0	34	5	0
14	a	William Hennessy (Ni														

Griffiths Valuation, Ballincarroona, Kilfrush, 1851

Patrick is another possible brother for John Leddin. Patrick Leddin married Anne Erwin.

Patrick and Anne had these children:

1. **Michael**, christened 24 April 1834 in Galbally.
2. **Margaret**, christened 10 February 1838 in Galbally. Michael Leddin was a sponsor at her christening.
3. **Maurice**, christened 22 October 1840 in Galbally.
4. **Patrick**, christened 23 April 1843 in Gallbally. Catherine Leddin was a sponsor at his christening.

5. **Catherine**, christened August 1846 in Galbally.

Another Michael is found in Galbally:

Michael Leddin married Mary Lenihan and had these children:

1. **Julia**, christened 4 May 1839 in Galbally.
2. **Michael**, christened 18 January 1843 in Galbally.
3. **Patrick**, christened August 1845 in Galbally.

Since this Michael of Galbally had a child christened in May of 1839, that means that Michael Leddin of Emly is a separate individual, as he had a child christened later in 1839. Michael of Emly is likely John Leddin's brother, as they lived in Emly at the same time. So, Michael of Galbally, and Patrick of Galbally are likely not John's brothers. They are probably the sons of Michael Leddin and Mary Ahern of Galbally.

In addition to Michael of Emly, William of Emly is also likely John's brother. Since William is known to be the son of Patrick Leddin and Margaret Gleeson, that means that Michael and John of Emly would also be their children.

FAMILY GROUP RECORD OF PATRICK LEDDIN AND MARGARET GLEESON

Patrick Leddin of Ballincarroona was born in about 1782, the son of William Leddin of Knocklong. He married Margaret Gleeson in about 1800. Patrick was a farmer.

Patrick is found in the Tithe Applotment in 1833 in Ballinacarroona. James Gleeson is a near neighbor, and was likely Margaret's father. Patrick farmed just over 13 acres, and paid a little over £1 in rent.

Ballinacarroona		1	2	3	4	5	6	7	8	9	10	11	12	13	14	15	16	17	18	19	20	21	22	23	24
John English	1	42	1 53																						
John English	1	30	1 53																						
John English	1	24	1 7																						
John English	1	37	1 25																						
John English	1	27	1																						
John English	1	41	1 7																						
John English	1	40	3 3																						
John English	1	37	1 25																						
John English	1	32	1 53																						
John English	1	6	34																						
John English	1	25	1 46																						
John English	1	29	3 24																						
John English	1	21	9																						
John English	1	19	3 3																						
John English	1	35	1 53																						
John English	1	20	34																						
John English	1	3	1 7																						
John English	1	25	3 24																						
John English	1	24	1 2																						

Tithe Applotment, Ballinacarroona



Ballinacarroona (Google Maps)

William Leddin occupied the land in Ballinacarroona in Griffiths Valuation in 1851, and Patrick may have died. A House Book written in 1849 describes the house:

Houses in Townland of <i>Ballincarroona</i>									
No.	Name and Description.	Quality Letter.	Length.	Breadth.	Height.	Number of Measures.	Rate per Measure.	Amount.	
								£	s. d.
<i>10</i>	<i>William Leddin House Office & Land</i>								
	<i>1-7-8</i>								
	<i>House</i>	<i>3C+</i>	<i>43.0</i>	<i>18.0</i>	<i>7.3</i>	<i>77</i>	<i>1/4</i>	<i>1.5</i>	<i>8 -</i>
	<i>Porch Hs</i>	<i>2C+</i>	<i>6.0</i>	<i>0.9</i>	<i>7.3</i>	<i>~</i>	<i>5/6</i>		
	<i>Office stable</i>	<i>3C-</i>	<i>7.6</i>	<i>10.65.0</i>	<i>7</i>	<i>7</i>	<i>1/4</i>	<i>11</i>	<i>5 -</i>
								<i>1.6.1 -</i>	
								<i>1.7.3</i>	

House Book for Ballincarroona

The house was 43 feet long by 18 feet wide and 7.3 feet tall. The house was rated 3C+ which was a thatched house of stone walls with mud mortar or mud walls of the best kind, old but in repair. There was a porch house which was 6 feet long by .9 feet long, and was a thatched roof house of stone or brick with lime mortar, also old but in repair. The property also had a stable, which was a thatched house of stone walls with mud mortar, old and dilapidated.

Patrick's wife Margaret is buried in the old Knocklong Cemetery. Her gravestone reads: "*This small testimony of sorrow was erected by William Leddin of Ballencarroona in memory of his mother Margret Leddin alias Gleeson who died the 30 Dec 1841 aged 59 years*".



*Gravestone inscription for Margaret Gleeson Leddin in Knocklong
(www.historicgraves.com)*

Patrick and Margaret had the following children:

1. **Michael**, married Ellen Ryan in 1831 in Emly.
- *2. **John**, married Ellen Purcell 1835 in Emly; married Mary Morrissy in 1838 in Galbally.
3. **William**, born in about 1810, married Johanna Condon 1834 in Galbally.
4. **Mary Ann**, christened 31 March 1813 in Hospital; married Lawrence Bourke 1831 in Hospital.
5. **Margaret**, christened 28 May 1815 in Hospital.
6. **Catherine**, born in Emly; married John Bourke.

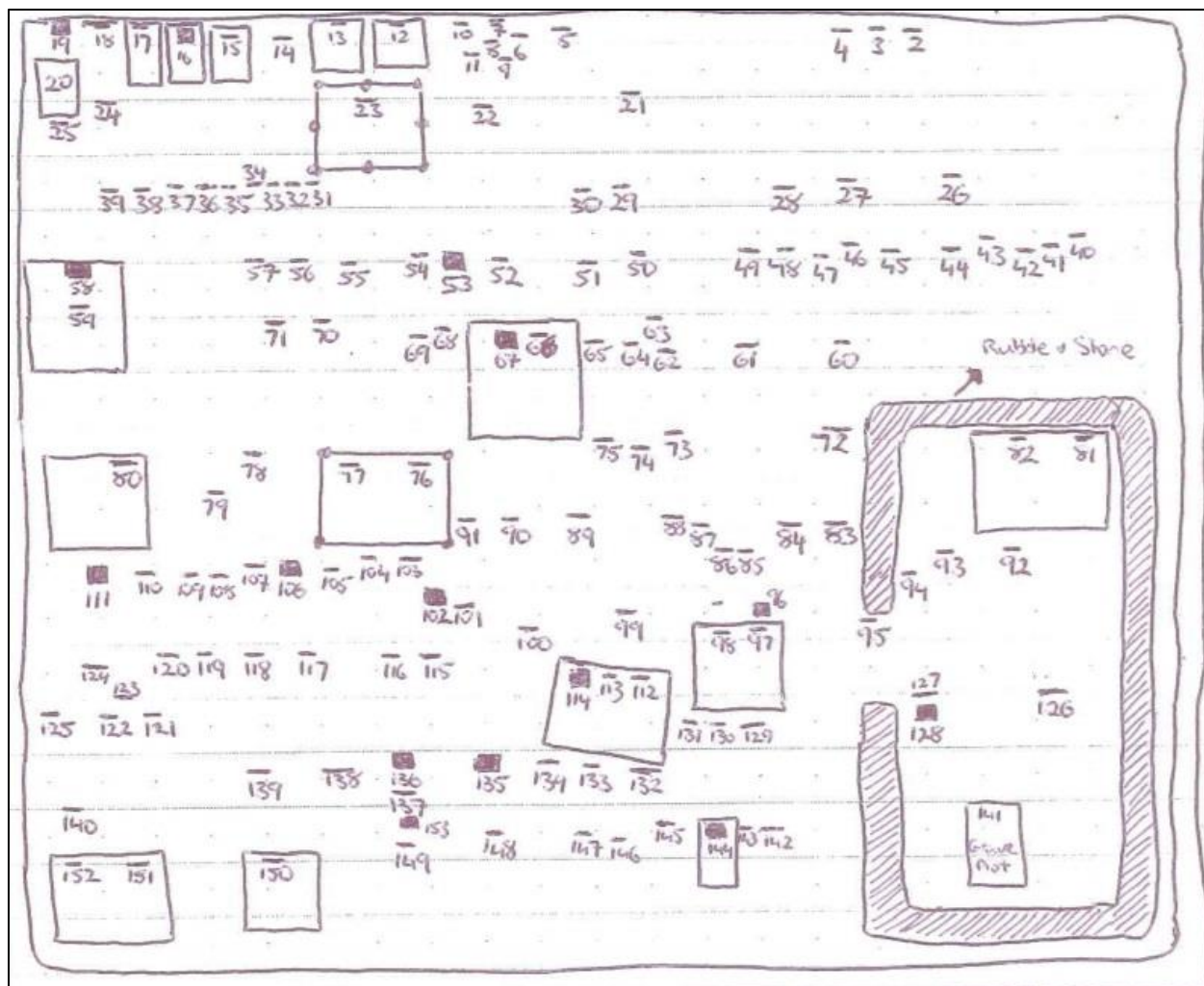

Map of the Hill of Knocklong cemetery -
 Margaret Leddin is buried in #84,
 William Lidden is buried in #72,
 his brother John Lidden is buried in #73

FAMILY GROUP RECORD OF WILLIAM LEDDIN

William Leddin was born in about 1761 of Knocklong. Family tradition through descendants was that William was "born in 1750 on a farm near the area of Knocklong, Co. Limerick. He married Elizabeth surname unknown, but they had two sons. One was called Timothy Leddin, born in 1792 and married Mary Judith Murphy". (Posting from Robert Anthony Halpin on genforum.genealogy.com, 4 September 2005; also [LeddinWarnerFamily on www.ancestry.com](http://LeddinWarnerFamily.ancestry.com)) These postings show Elizabeth as Patrick's mother. Elizabeth's father is shown as Patrick, with no last name shown. The source for this information seems to be family tradition, but no other source cited.

According to the monumental inscription on William's gravestone, William married Catherine Madden.

William's gravestone in the Hill of Knocklong reads:

*Erected by Catherine
Madden alias
Lidden in memory of
her Husband Willaim
Lidden who died June
29 1808 aged 47 yrs*

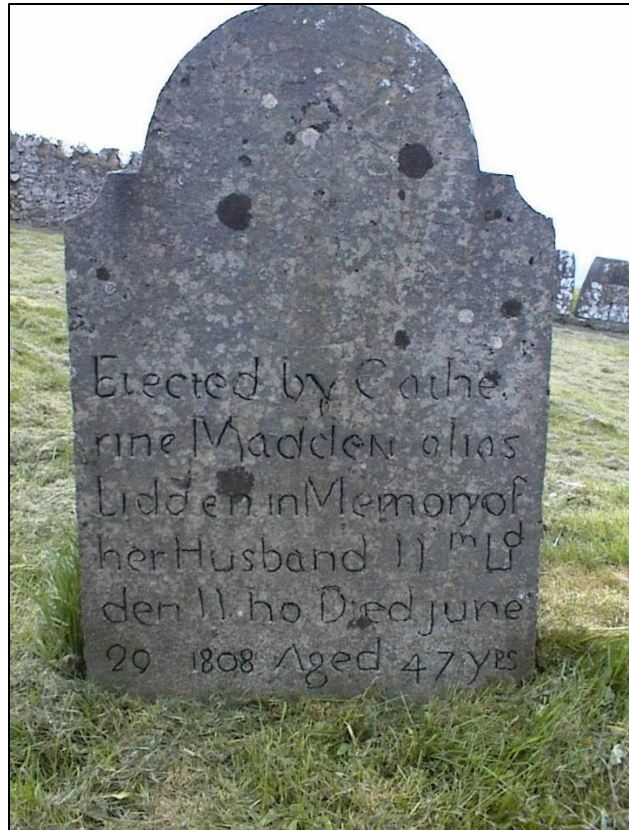

*Gravestone for William Lidden in the Knocklong cemetery
www.historicgraves.com*

Is this another marriage for William Leddin, or was Catherine Madden his only wife? Timothy, Patrick and Michael had daughters named Catherine. William may have married Elizabeth, with Catherine as a second wife, or perhaps Catherine was the only wife.

William did have a brother John, as recorded on a gravestone inscription in the Knocklong cemetery:

*Erected by Wm Lidden
in Memory of His Brother
John Lidden who
Died August 27 1809*

*Aged 40 yrs
May He Rest In Peace Amen*

John must have been born in about 1769 of Knocklong.



*Gravestone for John Lidden in Knocklong cemetery
www.historicgraves.co*

There is another Leddin gravestone in the Hill of Knocklong cemetery for John Gubbins, erected by his mother Mary Leddin. John died in 1819, aged 22 years, and so was born in about 1797. Mary, his mother, must have been born in about 1770, and may be a sister to William and John Leddin. The monumental inscription reads: "*Mary Leddin erected this in memory of her son John Gubbins who died April 10th 1819 aged 22 years. May he rest in peace, Amen.*"

William had the following children:

- *1. **Patrick**, born in about 1782 of Knocklong; married Margaret Gleeson; occupation: farmer in Ballincarooona.
2. **Michael**, born in about 1790 of Galbally; married Mary (Ahern?).
3. **Timothy**, born in about 1792; married Mary Murphy 26 July 1816 in Emly; occupation: farmer in Ballycahill; died 30 November 1880 in Ballycahill.



*Hill of Knocklong Cemetery,
the final resting place of the Leddins*

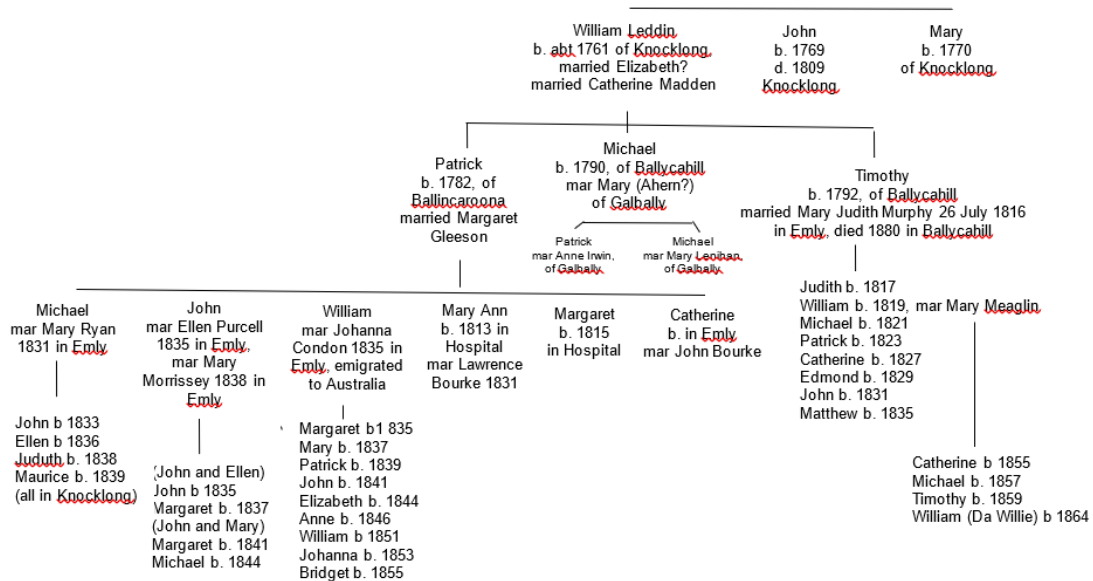

Leddin Pedigree

History of the Leddin Name

The name Leddin is an unusual name in Ireland. In the Irish phone book in 1990, all the Leddins were in

County Limerick. When the name Leddin is mentioned in Ireland, even many miles away, the response is, "They're from Hospital, County Limerick." Inquiries to Ireland have produced the following responses about the origin of the Leddin family:

"It is true that the name is uncommon and all the Leddins originally came from a village called Hospital in Co. Limerick. Emly is approximately 18 miles from Limerick." (Mrs. Evelyn Leddin, Limerick)

"It is fairly well established that the family arrived in Ireland circa 1690 or 1691. They came (from Holland or Germany) as Prussian mercenaries at the sieges of Limerick which occurred in those years. They settled in Limerick and became as the saying goes "more Irish than the Irish themselves." It is significant that they settled in Limerick. I have never met a Leddin who did not come from Limerick." (Tim Leddin, Limerick)

"I don't believe in the "Prussian mercenary" theory. As far as I have been able to ascertain, Leddin, Liddane, Leddy, Liddy are variations on an Irish name associated with Galway, though in the West it has assumed the forms of Leydon and Lydon." (Chris O'Mahoney, Regional Archivist for Limerick)

Leddin Name Variations

Gaelic: O'Loideain

Common variations: O'Leddan, which is a Munster variant of Liddane, Laden, Leyden, Lydon, (O) Lydon. Other forms are Leyden in Connacht and Clare, and Liddane mainly in Co. Clare.